

**addi**<sup>®</sup>  
MADE IN GERMANY

New instructions for the  
addiExpress Professional and  
addiExpress Kingsize  
knitting machines.

# Winding nautical ⚓ stitches ⚓





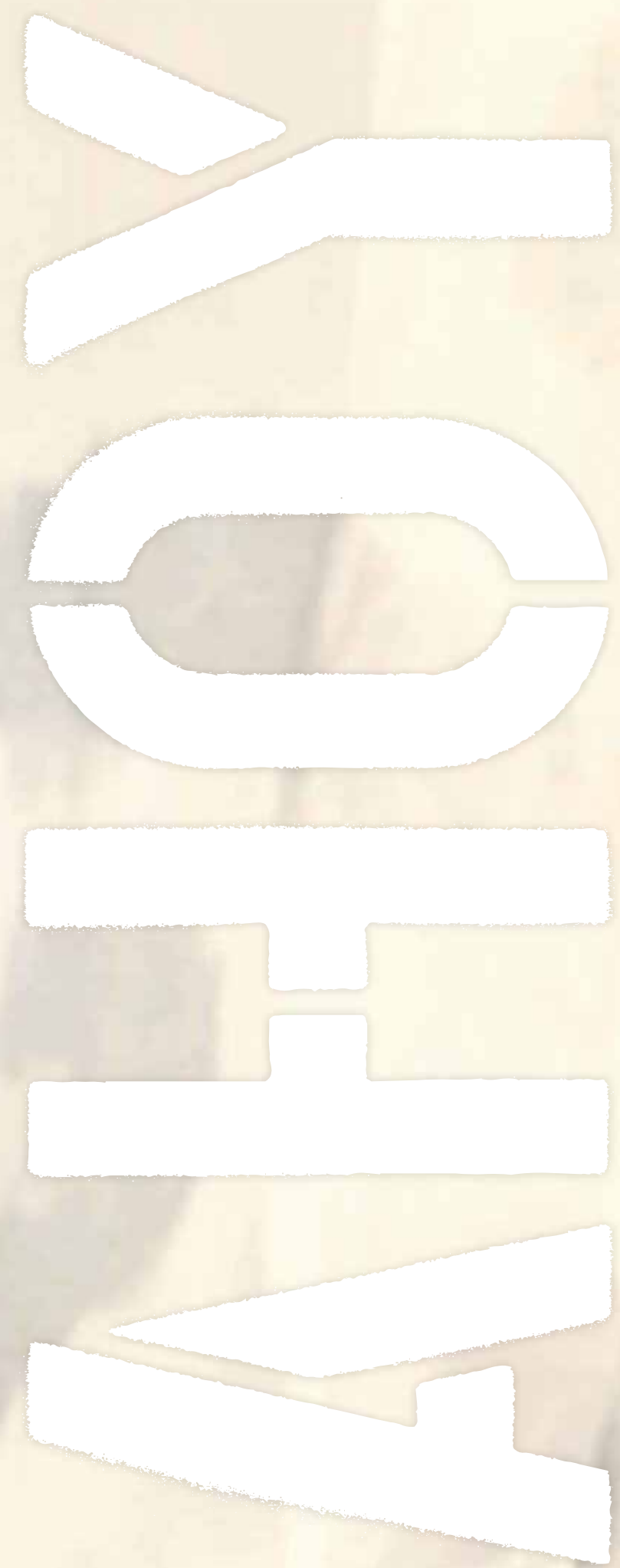

LEVEL OF DIFFICULTY

- Very easy X
- Easy XX
- Moderately challenging XXX
- Challenging XXXX
- Very challenging XXXXX

- 04 FOREWORD
- 06 BASIC COURSE IN addiExpress

addiExpress Kingsize

10	STRIPED BEANIE	X	approx. 1.5 hours
13	DOUBLE BEANIE / LOOP/COWL SCARF	X	approx. 2.5 hours
15	CUDDLY RIBBED SCARF	XX	approx. 3 hours
16	SCARF/SHRUG	XXX	approx. 4.5 hours
21	SAILORS AND FRIENDS TO CUDDLE	XXXX	approx. 4 hours per figure
30	NAUTICAL CUSHION FOR THE HOME 1	X	approx. 1.5 hours
30	NAUTICAL CUSHION FOR THE HOME 2	X	approx. 2.5 hours
33	NAUTICAL CUSHION FOR THE HOME 3	XX	approx. 4.5 hours
34	CHILDREN'S TENT OR PLAY BLANKET	XXXX	approx. 15 hours
37	JUMPER IN SIZE 42/44	XXXX	approx. 7 hours
41	CUDDLY WAISTCOAT	XXXXX	approx. 9 hours
43	LANTERN/LIGHTSHADE	XX	approx. 5 hours

addiExpress Professional

46	CLOTHES HANGER	X	approx. 2.5 hours per hanger
49	DOORSTOP	X	approx. 1.5 hours
51	(S)WARMING FISH	XXX	approx. 3.5 hours each
55	SEAT CUSHION/MAT	XXX	approx. 15 hours
58	TIPS + TRICKS		
72	IMPRINT		

# Basic course in addiExpress

## addiExpress Professional knitting output

- » Suitable for yarn counts 4-8
- » Circular knitting:  
approx. 10 to 15 cm diameter
- » Plain knitting:  
approx. 15 to 20 cm wide

## addiExpress Kingsize knitting output

- » Suitable for yarn counts 4-8
- » Circular knitting:  
approx. 35 cm diameter
- » Plain knitting:  
approx. 45 cm wide

- 1 Yarn holder
- 2 Row counter
- 3 Mode switch
- 4 Replacement needles
- 5 Plastic needle
- 6 Table clamps

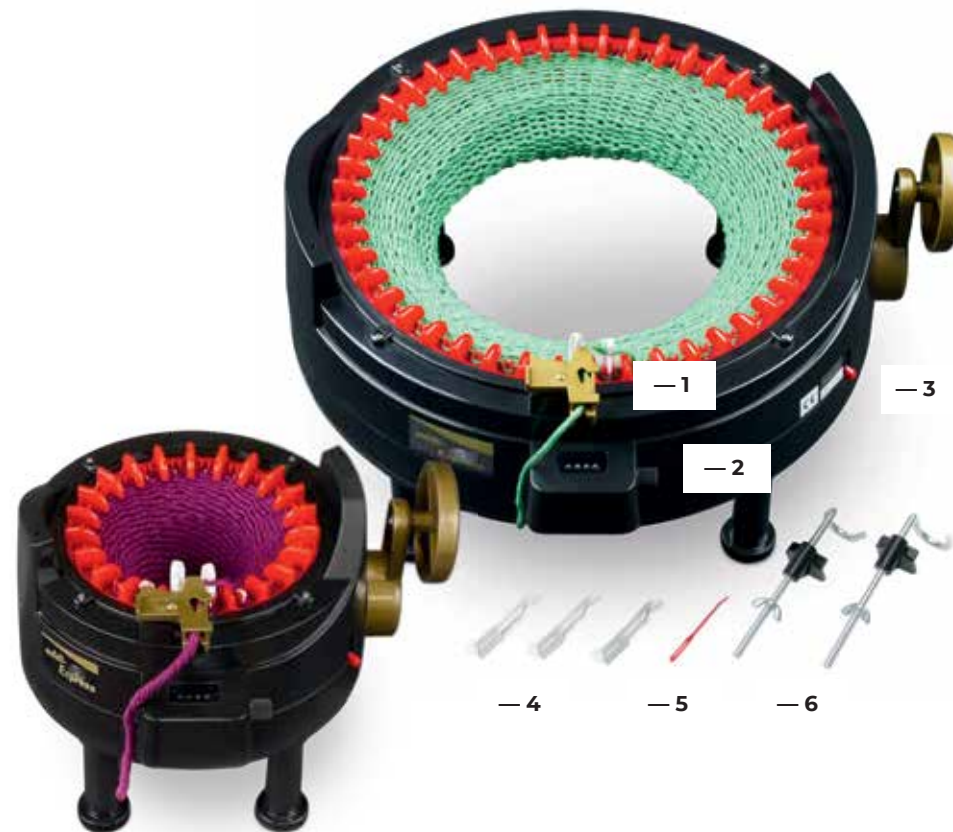

## SET UP

- 1 / Screw the supplied legs into your addiExpress.
- 2 / Place the addiExpress Kingsize at the edge of a table and affix it with the table clamps so it is in a firm position and will not slip.
- 3 / Turn the black knob to set the row counter to 0.

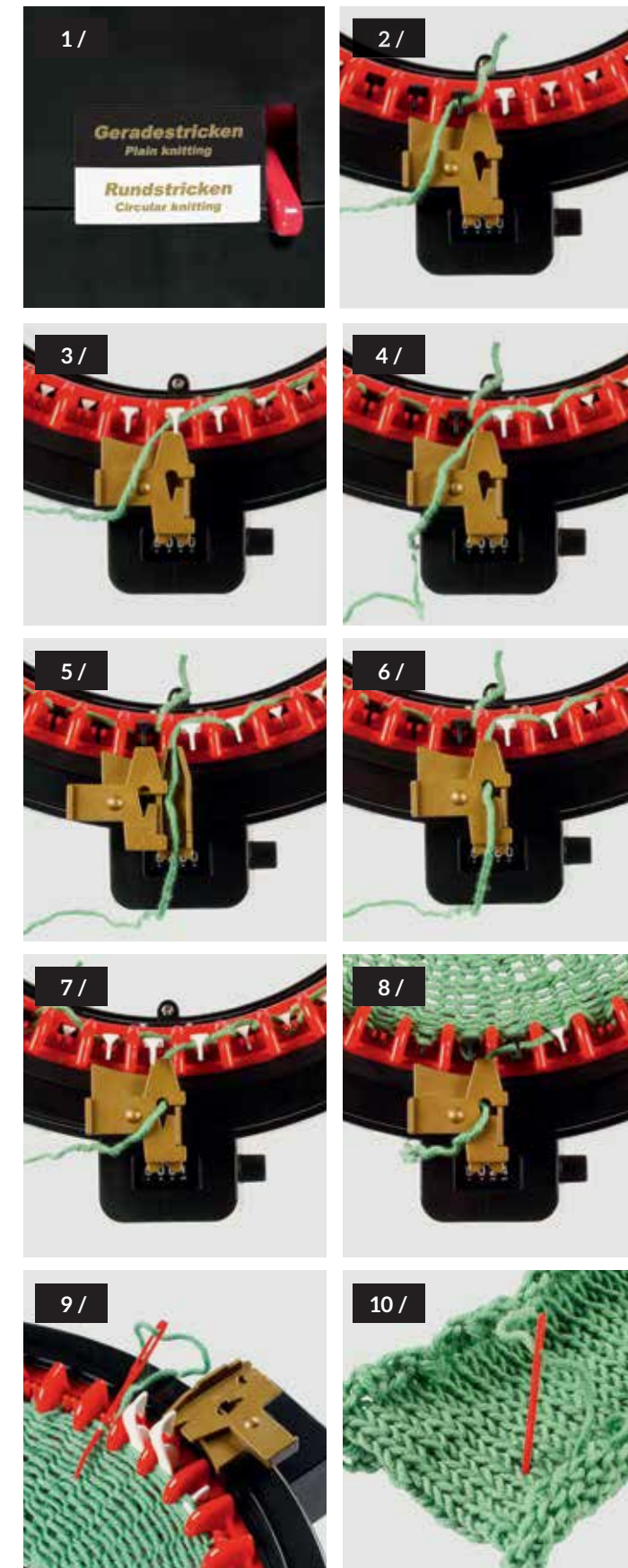

## Circular knitting basic course All 46/22 needles (Kingsize/ Professional) are used

- 1 / Before you start circular knitting, set the mode switch in the down position to "Circular knitting".
- 2 / Unroll some of the yarn. Put the start of the yarn in the middle of the addiExpress Kingsize so that it touches the table. Pass the yarn around the right one of the 3 black needles that is facing up.
- 3 / Slowly turn the handle clockwise. Keep the yarn constantly taut. Pass the yarn alternately in front of and behind the rising needles until you are back at the beginning.
- 4 / Once you are back at the beginning, the yarn runs outwards.
- 5 / Open the yarn holder by sliding it to the left. Insert the yarn until halfway. Close the yarn holder again. This is essential as otherwise winding is not possible and the needles may be damaged.
- 6 / Whether you feed the yarn backwards or upwards out of the holder depends on the yarn - it must run very evenly, without catching.
- 7 / Slowly and evenly turn the handle clockwise - do not force it, be gentle! With the other hand, make sure the wool is pulled in evenly. If the stitches are too loose on the needles, pull the knitted piece at the bottom.
- 8 / Once the knitted piece has reached the required length, cast off: Cut the yarn to about 85 cm long; pull it out of the holder and thread it into the plastic needle.
- 9 / Go clockwise through the addiExpress' top stitches. Lift the stitches between the red shafts; continue winding slowly. The yarn holder must be closed while you are doing this, otherwise the needles may be damaged.
- 10 / Once all the stitches have been cast off all round, the knitted piece is finished.



using a kitchener stitch in matching colour. This makes a nice invisible seam.

Roughly sew a contrasting marker thread of thick thread in the sides between each of the outer wales as a marker. Place marker threads on the 11.5th wale on the front and back for the foot and trouser area.

This makes it easier to find the quilting line that is now being knitted.

Proceed in the same way for the arm quilting lines.

Now place more marker threads on the front and back in this area after 5 st from the side markers. Using yarn and an embroidery needle with tip, now fix the seam exactly on the marked lines for the arms firmly using a lockstitch and tighten after each stitch, so that the legs and arms have a nice three-dimensional shape.

The details for each figure are described below:



Onno  
the sailor



## **MATERIAL**

- » **MERINO 70** from LangYarns, 100% new wool,  
Run length approx. 70 m/50 g
- 2 balls col 733.0001 white
- 1 ball col 733.0060 red
- 2 balls col T733.0025 navy
- 1 ball col 733.0033 light blue
- 1 ball col 733.0096 sand

- » 1 addiMoon

## **HERE'S HOW**

Knit in rounds following the stripe sequence:  
13 rounds light blue, 35 rounds navy,  
33 rounds 5 x (3 rd red, 3 rd white), 3 rd red,  
26 rounds sand, 20 rounds navy, continue for  
11 rd with double pointed needles in navy.

### **Hat brim**

Cast on 56 st in navy with the double pointed needles:  
14 st on each needle.

Knit 3 rounds of alternately 1 pl st, 1 p st.

1 rd pl st in white, 1 rd alternately 1 pl st, 1 p st in white,  
1 rd pl st in navy, 1 rd alternately 1 pl st, 1 p st in navy,  
1 rd pl st in white, alternately 1 pl st, 1 p st in white,  
1 rd pl st in navy, 4 rd alternately 1 pl st, 1 p st in navy.

Pull the edge of the hat, inside out, over the doll's body so that the rd with the stitches on the double pointed needles is pointing up on the coloured border between the face and hat area. Sew the hat brim to the 1st rd of the doll's hat using a kitchener stitch. Then loosely fold up the edge of the hat. Then it looks nice and three dimensional like a real hat!

### **Eyes**

2 eyes (pupil with iris):

Crochet 8 dc st in navy into a magic circle. Close the round with 1 slip stitch. Start at a different place for the 2nd round: crochet slip stitches with light blue, only inserting the hook into the back loop, Close the round with slip stitch. Sew the yarns and embroider the light reflex on the pupil in white.







Pick up a total of 72 st from the neckline using circular needle size 6. Knit 2 rd p st, then 7 rd 1 pl st, 1 p st alternately. Cast off with I-cord as described for the hem.

For the decoration on the jumper now knit a separate I-cord 3 times: cast on 80 st, cut yarn (leave approx. 10 cm). Start with the 1st st from the beginning and knit an I-cord again and finally join with 3 stitches to form a ring. 1 ring is applied below the 2 rd p st at the neckline, the other two are placed over the armhole seams.

If the measurements do not fit for the respective size:  
**P. 59 ADAPTING PATTERNS TO YOUR OWN SIZE.**



# Clothes hanger

If they could tell us, I'm sure many of them would complain about their dreary lives in dark closets or crowded wardrobes. Created for only one purpose, they fulfil it until the end of their lives, until they break with age. But that doesn't have to be the case. We help hangers find a new life. Decorative, padded hangers to protect delicate clothing can be easily created with the addiExpress. You might still have some old wire hangers from the dry cleaners, otherwise any clothes hanger will work for this as long as it has a bottom crossbar.

## MATERIAL

- » MERINO 70 from LangYarns, 100% new wool, Run length approx. 70 m/50 g
- 1 ball col 733.0001 white
- 1 ball col 733.0060 red
- 1 ball col 733.0025 navy
- » 1 coarse embroidery needle
- » 2 addi circular knitting needles no. 6, 40 cm
- » 1 addi crochet hook no. 4.5
- » 1 wire clothes hanger  
(from the dry cleaner or from the internet)
- » 1 pipe insulation from the hardware store, 3 cm diameter
- » 1 bottle of "Marabu Plus" fabric paint, 15 ml in white, Art. 17150 039
- » 1 bottle of "Marabu" fabric paint, 15 ml in dark blue, Art. 17160 039

- » 1 cutter and ruler
- » 1 cutting mat
- » 1 Staedtler Lumocolor, F thickness in black, "permanent"
- » 1 pack of A4 stencil sheets from [www.qbixbrand.com](http://www.qbixbrand.com)
- » 1 small sponge
- » 1 addiExpress

## LEVEL OF DIFFICULTY ×

TIME REQUIRED approx. 2.5 hours per figure

## HERE'S HOW

Knit in "Plain knitting" mode over 19 st. Knit a few rows with spare yarn (**P. 58 KNITTED FINISHES**), then continue knitting stripes in the following order with MERINO 70 for the 1st clothes hanger:

Pull the inner cover into the knitted doorstep cover, pull out the loop and sew the narrow side of the knitting together using the kitchener stitch. Work around the crocheted cord.

Do the same way on the other side.  
Finished!!





### Stripe embroidery on model 1

A few white lines as decoration in stem stitch on the cover (see photo) make your creation look even better.

### Fin for model 1

Crochet 41 ch in ink blue, crochet 1 row with arranged clusters\*.

\*Clusters: insert 1 yarn-over into the st with the crochet hook, pick up the yarn and pull it through the st, 3 x (insert 1 yarn-over into the same st, pick up the yarn and pull it through the st), pick up the yarn and pull it through all 9 loops on the hook).

Arrange the clusters as follows:

2 ch, 1 cluster in the 1st base ch, \*(3 ch, 1 cluster in the 1st ch, skip 1 st in the base ch, 1 cluster in the following st). Rep from \*.

Attach the fin to the top seam of the cover.

### 2 eyes for model 2

14 ch in navy, back row with sl st. This stripe is sewn like "eye shadow" just behind the front and upper side of the assembled eye. Fix the eye on the cover, also embroider a few eyelashes.

### 12 dots for model 2

Crochet 10 tr in a magic circle and close the round with sl st. Distribute 6 dots on each side of the cover as you like.

### Mouth for model 2

Lower lip: crochet 16 ch in red.

Back r: 3 sl st, 2 ch, 2 htc, 3 tr, 2 htc. 2 dc st, 3 sl st

Upper lip: crochet 20 ch in red.

Back r: 3 sl st, 2 dc st, 2 htc, 2 tr, 3 dtr, 2 tr, 2 htc, 2 dc st, 3 slip stitches. Place both lips around the narrow side edge of the cover and attach them.

### Fin for model 2

Crochet 41 dc st in ink blue.

1st r: 1 tr in 3rd ch from crochet hook, then 1 tr per st.

2nd r: 2 turning ch, \*1 front post treble crochet around the 2nd tr in previous row, 1 back post treble crochet around the 3rd tr in previous row. Rep from \*.

3rd r: 2 turning ch. (The post treble crochet are now arranged offset: a back ptr is now placed on a front ptr appearing in this row and vice versa).

\*Back post treble crochet around the 2nd post treble crochet in the

previous row, front post treble crochet around the 3rd post treble crochet in the previous row. Rep from \*.

4th r: crochet 1 row in rev dc in red over the narrow side, long side and 2nd narrow side of the fin.

Sew the fin in place over the cover's side seam.







